

HAMBEL'S SUBDIVISION

MALTA TOWNSHIP SECTION 10 & 11 R-12 TWP-10 MORGAN COUNTY, OH

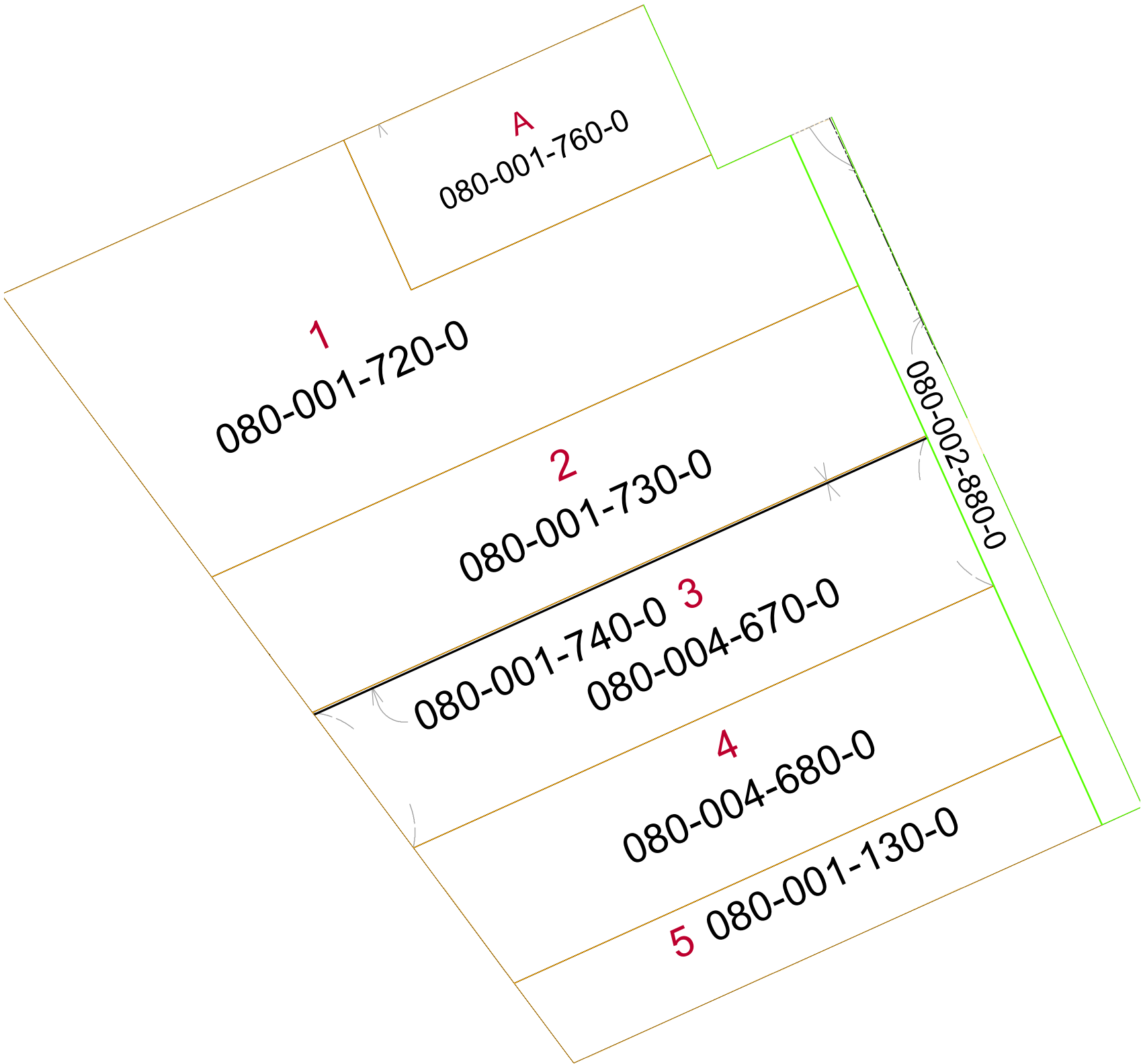

PIN	VOL	PAG	Owner	LegalDescr	Acres
080-001-130-0	D.V 157	233	BARKHURST PAUL D & DOROTHY R	IN LOT 5 HAMBEL'S ADDI	0
080-001-740-0	OR217	787	JARVIS DAVID A	IN LOT 3 HAMBEL'S ADD	0
080-001-730-0	OR217	787	JARVIS DAVID A	IN LOT 2 HAMBEL'S ADD	0
080-001-720-0	OR217	789	JARVIS DAVID A	IN LOT 1 HAMBEL'S ADD	0
080-001-760-0	OR217	789	JARVIS DAVID A	OUT LOT 6 FAIRMOUNT A	0
080-004-680-0	OR166	713	SWANK STEVEN R & WESLEY STEVEN	IN LOT 4 SURVIVORSHIP	0
080-004-670-0	OR166	713	SWANK STEVEN R & WESLEY STEVEN	IN LOT 3 SURVIVORSHIP	0

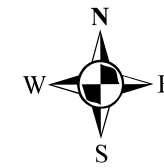

Boundaries	
-----	Hidden
-----	Roads
-----	County
-----	Hydro
-----	Lot
-----	Parcel
-----	Section
-----	Township
-----	ROW
-----	Parcels

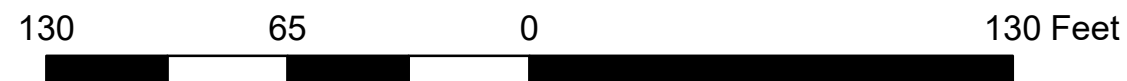

Disclaimer: The information that these maps contains is for reference purposes only. Please bring any erros to the attention of the Engineer's Office staff.
Thank you